

# SlowStop® Energy Absorbing Bollard Type 3 – 168mm (49-SSB168)

The strongest surface mount bollard available. For maximum protection in the most difficult applications.

Color: RAL 1023 Yellow Bollard on RAL 9005 Black Base

Diameter:

Height: 168 mm (7.1 mm wall)  
1000 mm

Set Screws: 8 M16 x 2,00  
8mm Hex

Cap: Black Plastic

Installs with eight (8)  
Concrete Screw Anchors

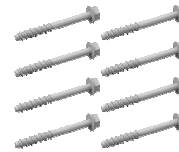

MASS (KG)	2000	4000	6000	8000	10000	15000	20000	25000	30000	35000	40000
SPEED (KPH)											
3.0	Green	Green	Green	Green	Green	Green	Green	Green	Green	Green	Green
3.5	Green	Green	Green	Green	Green	Green	Green	Green	Green	Green	Green
4.0	Green	Green	Green	Green	Green	Green	Green	Green	Green	Green	Green
4.5	Green	Green	Green	Green	Green	Green	Green	Green	Green	Green	Green
5.0	Green	Green	Green	Green	Green	Green	Green	Green	Green	Green	Green
5.5	Green	Green	Green	Green	Green	Green	Green	Green	Green	Green	Green
6.0	Green	Green	Green	Green	Green	Green	Green	Green	Green	Green	Green
6.5	Green	Green	Green	Green	Green	Green	Green	Green	Green	Green	Green
7.0	Green	Green	Green	Green	Green	Green	Green	Green	Green	Green	Green
7.5	Green	Green	Green	Green	Green	Green	Green	Green	Green	Green	Green
8.0	Green	Green	Green	Green	Green	Green	Green	Green	Green	Green	Green
8.5	Green	Green	Green	Green	Green	Green	Green	Green	Green	Green	Green
9.0	Green	Green	Green	Green	Green	Green	Green	Green	Green	Green	Green
9.5	Green	Green	Green	Green	Green	Green	Green	Green	Green	Green	Green

No Damage / Negligible Damage  
Will Stop / Potential Damage to Guard  
Guard is under-sized

## SPECIFICATIONS

- Stopping Power Rating: 25.800 joules
- Temperature Rating: -40° to 70°C
- Pipe Coating: EN-ISO 1461 Galvanized + Polyester Powder Coat
- Base Coating: Environmentally Friendly Water-Based KTL Coating + Polyester Powder Coat. C5I corrosion resistance.
- Frangible base eliminates floor damage. Safe for structural concrete.

## RECOMMENDED USES

- Loading Docks and Warehouse Entrance Ramps
- Equipment Guarding
- Wall and Door Protection
- Utility Protection
- Pedestrian Safety
- Fuel Pump Protection
- Storage Tanks
- Not for Hostile Vehicle Security

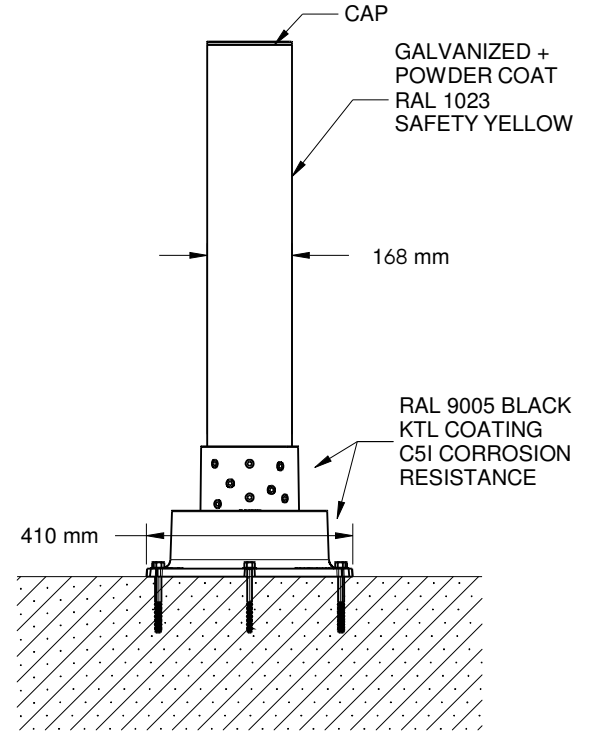
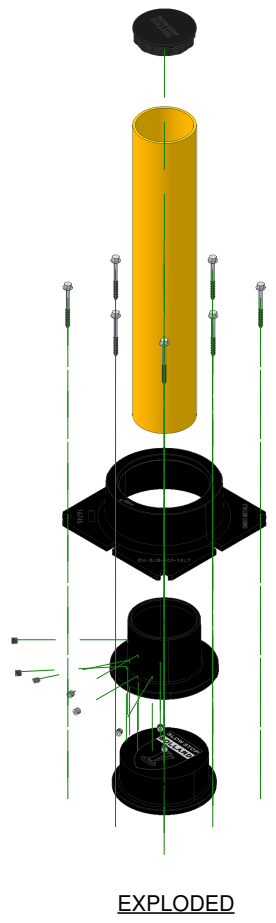
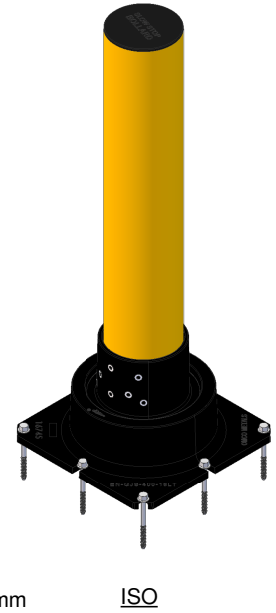
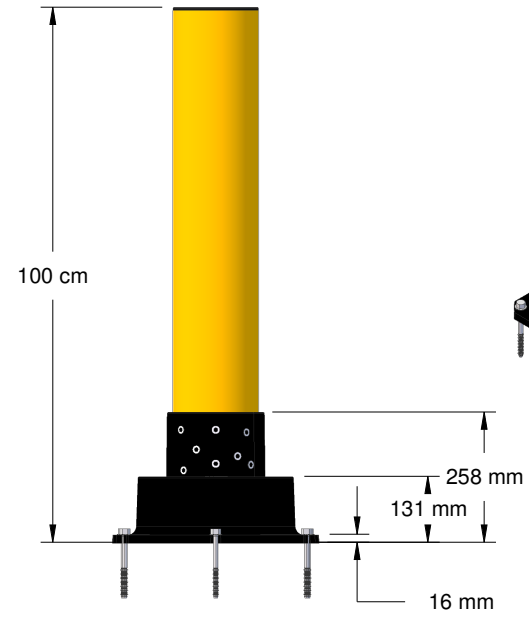
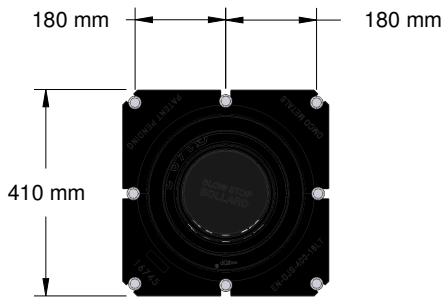

\* MINIMUM FOUNDATION DEPENDS ON LOCAL SOIL CONDITIONS, WEATHER & ENG. REQ'TS

DETAIL



CONFIDENTIAL & PROPRIETARY

The drawing on this print and the information therewith are property of SlowStop Guarding Systems, LLC, and shall not be used or discussed in whole or in part without the consent of SlowStop Guarding Systems, LLC.

VANGUARD GROUP LTD

0800 500 147

SIZE  
**A**

PART NO.  
49-SSB178

DWG.  
SlowStop® Energy Absorbing Bollard – 178mm

REV  
**2.0**

SCALE

DATE  
13-JUN-2017

