



Suggested Uses.

- Deter skateboarding on long edge street furniture

Benefits.

- Eliminates potential damage caused to property and architecture by skateboards, bicycles and skates.
- Manufactured from polished marine grade 316 stainless steel to suit square edge and rolled edge landscape walls and other ledges.
- Electro polished finish

Useful Tip.

Suggested spacing is 500-600mm between each Skate Deterrent

Specifications.

| | |
|--------------------------|--|
| Code | 12-SDC |
| Description | Cylindrical Stud Skate Deterrent |
| Material | 316 Stainless Steel |
| Stud Height Above Ground | 10mm |
| Stud Diameter | 20mm |
| Stem Height | 30mm |
| Stem Diameter | 6mm |
| Pack Qty | 10 units |
| Fixings | 1 tube adhesive per 20 units installed |

Fixings.

| | |
|-----------|---------------------------------|
| 49-AF3001 | Anchorfix Adhesive - 300ml Tube |
|-----------|---------------------------------|

Installation.

Concrete Surface & Timber Surface:

Drill 8mm hole in substrate. Half fill hole with suitable Epoxy Adhesive. Position skate deterrent and leave undisturbed till Epoxy has set.

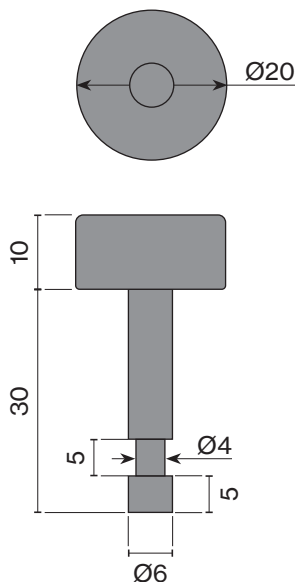

Scan here to view the webpage.

